

DS CODE:
300103

LS Simple™ Cabling Solution

LS-PP-UC6-24P-WM-EC

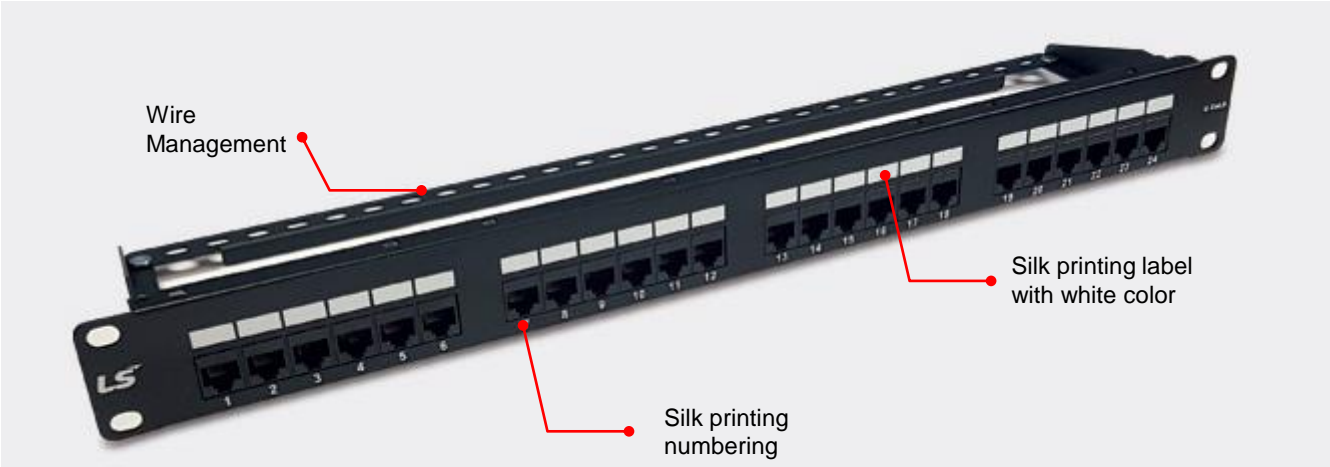

Description

LS Simple™ PCB type 1Unit 24-port unshielded patch panel comes complete with accessories & full instructions. It fully complies with the ANSI/TIA-568.D-2(Category 6), RJ-45 of 47 CFR part 68 and ISO/IEC 11801 standards. The panel modules are individually terminated using IDC giving assurance of wire connection and using punching down tool (LS-TOOL-MJ or LS-STOOL). Additionally enclosed Wire Management for managing cabling.

Application

- Horizontal Distribution & Backbone Cabling
- 4/16 Mbps Token Ring (IEEE 802.5)
- 10/100/1000 BASE-T (IEEE 802.3)
- 155 Mbps ATM
- 100Mbps TP-PMD
- ISDN, ADSL
- RoHS2 compliant
- ATM LAN 1.2G

Part Numbers

Description	Dimension (H x W xD mm)	Part Numbers	Compatible Items
24-Port Category 6 Unshielded Patch Panel	44x482.5x30.9	LS-PP-UC6-24P-WM-EC	19" standard rack 1unit Tool: LS-TOOL MJ or LS-STOOL

DS CODE:
300103

LS Simple™ Cabling Solution

LS-PP-UC6-24P-WM-EC

➤ Technical Details

Item	Unit	Information
FEATURE Approvals Category Meet Wiring scheme		UL, KC ANSI/TIA-568.D-2 (Category 6) CFR 47 Parts 68 T568A/T568B
ELECTRICAL Current Rating Insulation Resistance Contact Resistance DC Resistance Voltage proof	Amps Mega-ohm milli-ohm milli-ohm V _{DC}	1.5 > 500 < 20 < 200 < 1000
MECHANICAL Insertion Life Pull Force Temperature Humidity IDC accept	Mating cycles lbs(N) °C % AWG	750 mating cycles 20lbs (89N) -10°C ~ 60°C 10% ~ 90% RH 22~24 (Solid wire), 200 termination cycles
PHYSICAL Panel Plastic frame Jack contacts IDC Plastic IDC Terminals Wire Management		SPCC ABS, UL94V-0 Phosphor bronze, 50μ-inch gold coating PC, UL94V-0 Phosphor bronze, tin over nickel undercoat SPCC

DS CODE:
300103

LS Simple™ Cabling Solution

LS-PP-UC6-24P-WM-EC

Drawing

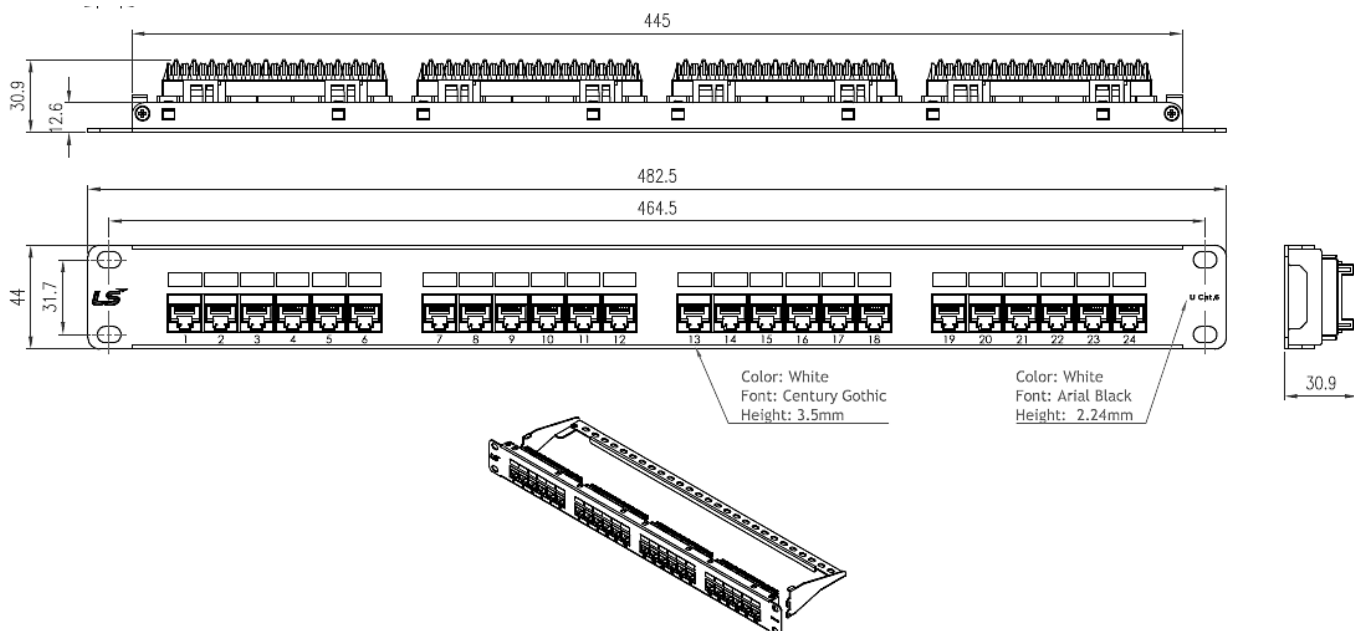

DS CODE:
300103

LS Simple™ Cabling Solution

LS-PP-UC6-24P-WM-EC

Instruction

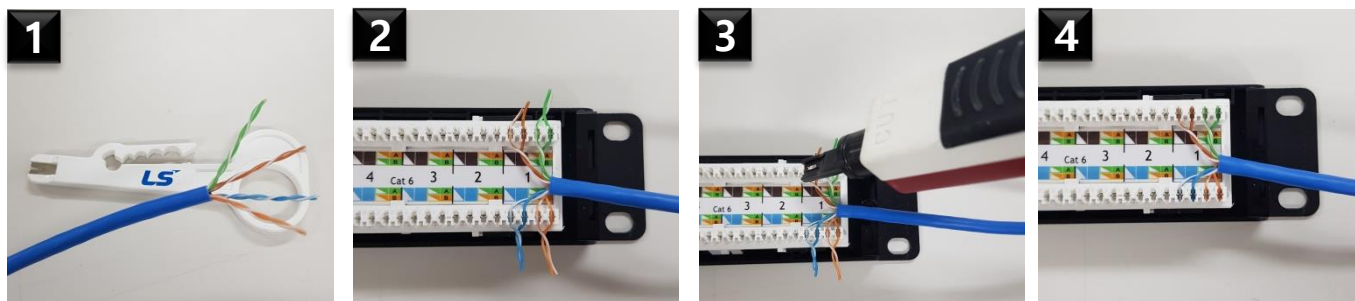

1. Strip the sheath about 40mm
2. Arrange the insulation wire to IDC slots according to T568A/B wiring scheme

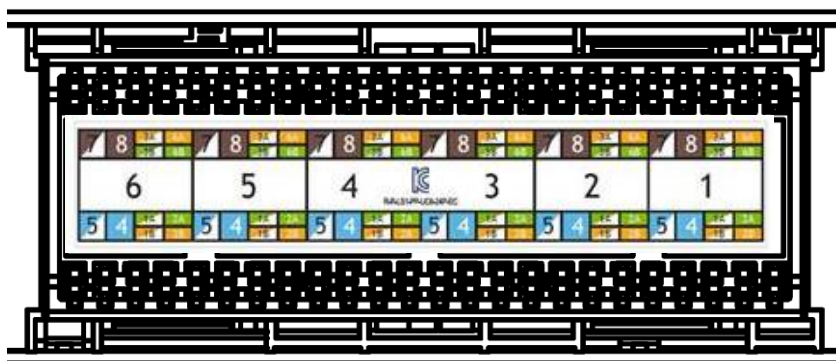

TIA568A	WH/BR	BR	WH/OR	OR	TIA568B	WH/BR	BR	WH/GN	GN
	WH/BL	BL	WH/GN	GN		WH/BL	BL	WH/OR	OR

3. Terminate the cable and cut the insulation wire by 1-pin IDC punch tool
4. Check the wiring scheme and the cable termination

* Caution

- Do not make untwisted length more than 12.7mm for performance such as cross talk
- Always use 1-pin tools and do not use multi-pin tools such as 8-pin type
- Use only 1-pin tool or nipper for cutting excess wires of IDC blocks (knife X)
- Make sure that the radius of curvature is about 24mm when organizing the cable